

PARTS LIST AND INSTRUCTIONS

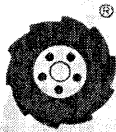

Wheel Horse

WHEELHORSE PRODUCTS, INC. • SOUTH BEND, IND.

ROTARY MOWER RM-484

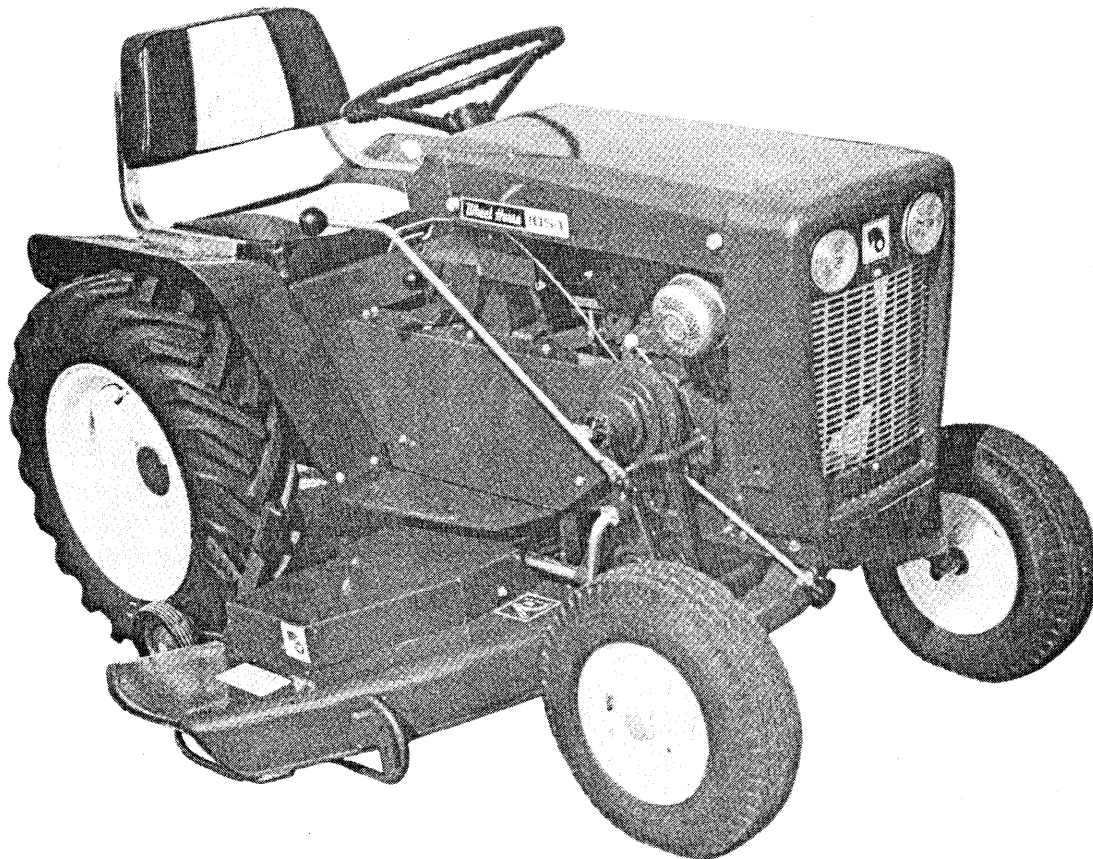

ASSEMBLY

Remove mower from box. Remove right bearing Part 4280. Insert gauge wheel adjusting rod in left bearing. Reinstall right bearing and tighten securely. Install notched arm, Part 4799, through loop in adjusting handle with notches down, secure with hair pin cotter. Fasten spring, Part 1230 from cotter pin in arm to cotter pin in deck.

Install idler mounting bracket, Part 4400, by inserting leveling rod, Part 4399, through deck as shown in Figure 1. Insert idler support shaft, Part 4286, into idler mounting bracket and deck as shown in Figure 1. Secure with (4) $\frac{3}{4}$ " washers, Part 1278 and (4) $\frac{5}{32}$ x $1\frac{1}{2}$ " cotter pins, Part 932026-4.

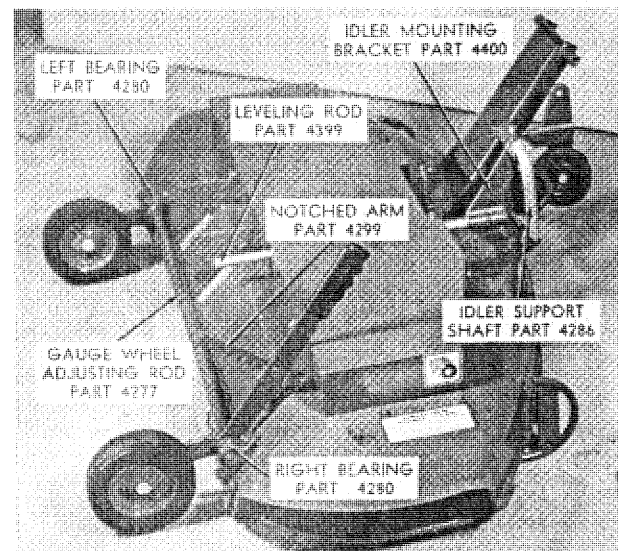

Figure 1

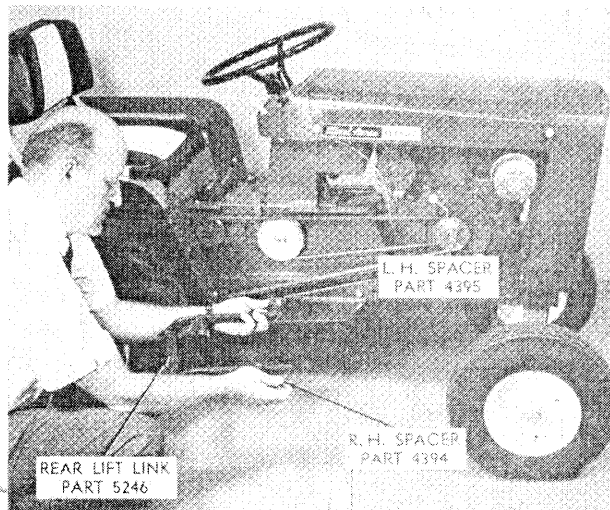

Figure 2

Remove right hand tractor guard (Tractor Part 2782) and left hand tractor guard (Tractor Part 2783).

Remove rear lift link, Part 5246, from mower. Install right hand spacer, Part 4394, in right link arm and left hand spacer, Part 4395, in left arm.

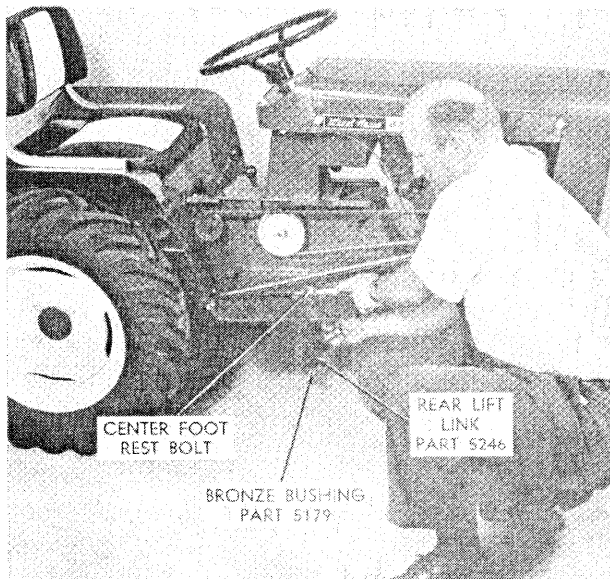

Figure 3

Remove center bolts from foot rests on each side of tractor as shown in (Figure 3). Install rear lift link with spacers in place using $\frac{3}{8}$ " x $1\frac{1}{4}$ " bolt, Part 908333-4 on right side and $\frac{3}{8}$ " x 2" bolt, Part 908336-4 on left side. The $\frac{3}{8}$ " washers, Part 920009-4 must be used on inside before securing with $\frac{3}{8}$ " nylock nuts, Part 915113-6. Re-install tractor guards.

NOTE: Once installed, this rear lift link will remain a part of the tractor. When the mower is removed the link should be swung to the rear, up between the frame. The latch, Part 4390, which is a part of the link, should be hooked over the left frame rail to hold the link in this position so that it will not interfere with other attaching tools.

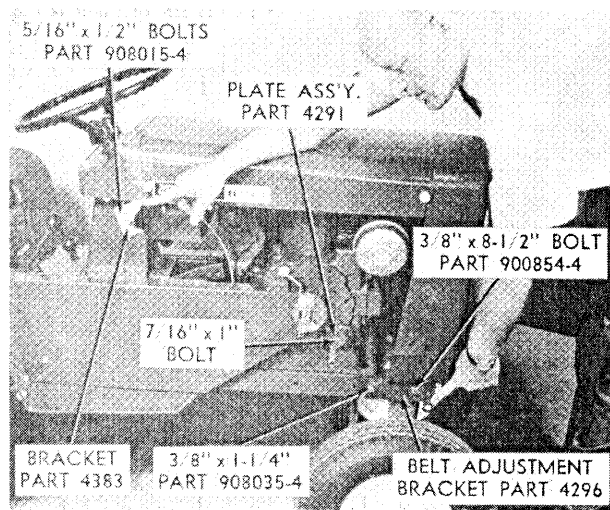

Figure 4

Mount plate assembly, Part 4291, to engine face by removing $\frac{7}{16}$ x 1" bolt (which holds lower belt guide angle on) and place plate assembly in position as shown in Figure 4. Replace bolt and lockwasher and tighten.

Install bracket, Part 4383, to tractor as shown in Figure 4 using (2) $\frac{5}{16}$ " x $\frac{1}{2}$ " bolts, Part 908015-4 and $\frac{5}{16}$ " lockwashers.

Install belt adjustment bracket as shown in Figure 4 using $\frac{3}{8}$ " x $8\frac{1}{2}$ " bolt, Part 900854-4 in the front hole of the tractor frame and the $\frac{3}{8}$ " x $1\frac{1}{4}$ " bolt, Part 908035-4 in the rear bracket hole.

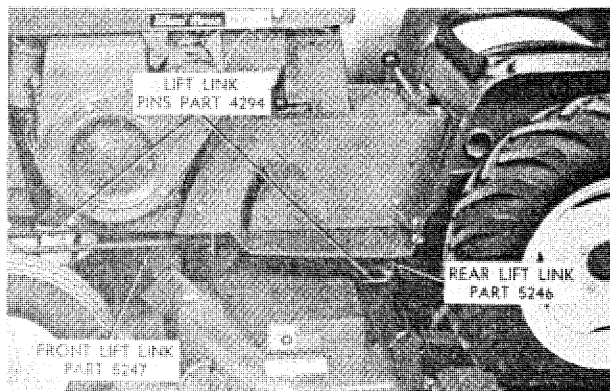

Figure 5

From the right side of the tractor, slide the mower underneath so that the front lift link is on center line of tractor. Place lift link in position between tractor frame. Insert lift link pin, Part 4294, through lift link from left side of tractor as shown in Figure 5.

NOTE: The lift link pin goes in fourth hole of tractor frame and pin handle goes in second hole of frame. Secure with hair pin cotter, Part S-52-4.

Swing the rear lift link down between the rear mounting brackets on mower deck. Insert the other lift link pin through center holes into rear mounting bracket and place pin handle into hole provided in bracket as shown in Figure 5. Secure with hair pin cotter, Part S-52-4.

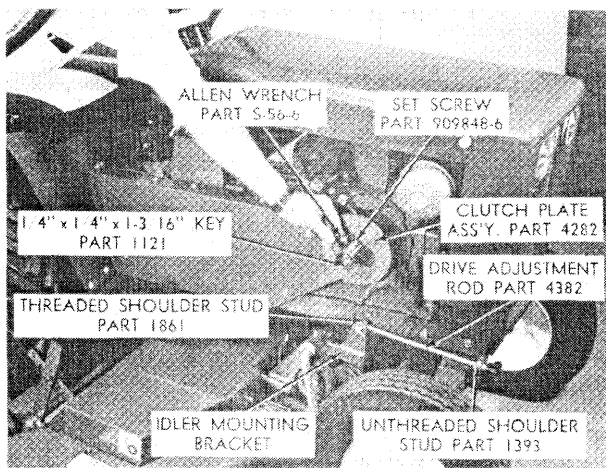

Figure 6

Insert $\frac{1}{4} \times \frac{1}{4} \times \frac{3}{16}$ " key, Part 1121, in engine shaft. Slide clutch plate assembly, Part 4282, on shaft until engine shaft is against snap ring inside clutch plate assembly. Secure in place by tightening set screw, Part 909848-6, with allen wrench, Part S-56-6 as shown in Figure 6.

Install unthreaded shoulder stud, Part 1393, in belt adjustment bracket as shown in Figure 6 and secure with $\frac{1}{8}$ " x 1" cotter pin. Install threaded shoulder stud, Part 1861 in idler mounting bracket as shown in Figure 6. Secure with $\frac{1}{8}$ " x 1" cotter pin.

Install drive adjustment rod, Part 4382, through unthreaded shoulder stud and turn into threaded shoulder stud as shown in Figure 6.

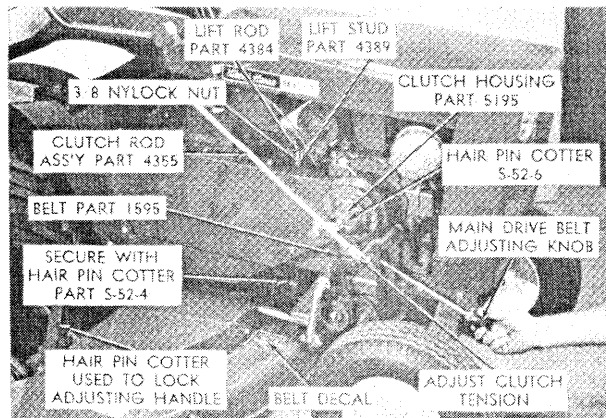

Figure 7

Slip clutch housing, Part 5195, over clutch plate assembly as shown in Figure 7.

Install belt, Part 1595, as shown in Figure 7. Refer to belt decal on mower deck for arrangement. Adjust belt tension by tightening drive adjustment as shown.

Install clutch rod assembly, Part 4355, as shown in Figure 7 using (2) $\frac{3}{8}$ " nylock nuts, one on each side of the fork shaped rod end. Insert hair pin cotter, Part S-52-6 through clutch housing and into plate on clutch rod. (REFER TO OPERATING INSTRUCTIONS FOR CLUTCH ADJUSTMENT).

Install lift stud, Part 4389, from the right side of tractor into lift arm and secure with hair pin cotter, Part S-52-4. Install lift rod, Part 4384, up through lift stud, put $\frac{3}{8}$ " nylock nut on end of rod. Insert L shaped end through bracket on deck of mower as shown. Secure with hair pin cotter, Part S-52-4.

Raise hydraulic lift to up position and adjust nut so that mower stops are firmly against the tractor frame.

OPERATION

I. CUTTING HEIGHT

The height of cut is adjustable from a minimum of $1\frac{3}{8}$ " to a maximum of 4" by adjusting the gage wheels. The mower can be raised with the hydraulic lift, higher than 4" until the stops touch the frame. This is the transport position. The lock nut on the lift rod (Figure 7) should be adjusted to make sure both stops on the mower are firmly against the tractor frame with the hydraulic lift in the extreme up position.

A hairpin cotter is used through a small hole in the gage wheel adjusting handle to lock handle in the notch you select.

II. BELT ADJUSTMENT

The main drive belt, Part 1595 goes from the large groove of the engine mounting clutch, over two idler pulleys and then to the upper groove of the center pulley on the mower. (Refer to the belt arrangement as shown on the belt decal on the mower deck). Tension of this belt is adjusted by tightening knob (Figure 7). The blade drive belt, Part 1594, drives the three blades. (Refer to belt arrangement as shown on the belt decal on mower deck, if you replace this belt.)

III. CLUTCH OPERATION AND ADJUSTMENT

The mower is started and stopped by operating the engine mounted clutch. By moving the clutch rod from the outside notch in the bracket, to the inside notch, (toward the tractor), the friction clutch is engaged. The other end of this rod is fork shaped with a $\frac{3}{8}$ " locknut on each side. By moving these nuts in toward the tractor, more tension will be applied to the clutch. Adjust nuts so that clutch just disengages with clutch rod in middle notch (above arrow) of bracket, Part 4383. Refer to decal on bracket. There are two grooves in the clutch for V-Belts, be sure the main drive belt is in the larger of the two. (Closest to the engine.) The other small groove is to drive other attaching tools.

OPERATING HINTS

- A. The three blades rotate to the right, so that discharge is out the right side of the deck through the discharge opening. Mower discharge should be toward cut portion of lawn for even distribution of grass. **Sharp** blades are necessary for good mowing. When the blades become dull, remove and regrind.

NOTE: SHARPEN EVENLY SO BLADE DOES NOT BECOME OUT OF BALANCE.

CAUTION: INSPECT BLADES FREQUENTLY, (ESPECIALLY AFTER HITTING AN OBJECT), TIGHTEN IF NECESSARY.

For best cutting, tractor should be operated at full throttle in 2nd gear. In extremely heavy cutting, it may be necessary to use 1st gear.

- B. When mowing extremely heavy grass, raise the mower to the travel position and cut. Then re-cut at normal height. Don't cut grass too short. Ideal length is 2" to 3". Cut a short distance and measure to be sure.

LUBRICATION

There are four grease fittings on the mower. One for each of the spindles and one for the idler mounting bracket. All are easily accessible from the top of mower. Each spindle has a grease fitting visible through a hole in the top of the deck. Spindles have been greased at the factory, but should be greased again before operation and after every 5 hours of use.

The clutch housing has a needle bearing pressed inside with a grease seal. This bearing has been greased at the factory. Every 25 hours the clutch housing should be removed and a **SMALL** amount of good quality grease applied to partially fill the spaces between the rollers.

Oil all other moving parts twice daily with a light grade of machine oil.

PARTS LIST FOR RM-484 ROTARY MOWER

When ordering parts always list Part No. and name of part.

Ref. No.	Part No.	Description	No. Req'd.	Ref. No.	Part No.	Description	No. Req'd.
1	4257	Ass'y. Deck	1	57	4294	Ass'y. Pin Lift Link	2
2	5193	Ass'y. Channel — Deck Support	1	58	S-52-4	Hair Pin	4
3	4299	Housing	1	59	4361	Ass'y. Skid	2
4	1508	Bearing	1	60	908018-4	Bolt — Hex $\frac{5}{16}$ -18 x $\frac{7}{8}$	4
5	1303	Seal — Oil	1	61	4400	Bracket — Idler Mtg.	1
6	900063-4	Bolt — Carriage $\frac{3}{8}$ -16 x 1	16	62	4399	Rod — Leveling	1
7	900062-4	Bolt — Carriage $\frac{3}{8}$ -16 x $\frac{3}{4}$	5	63	933156	Roll Pin $\frac{1}{8}$ x 1	2
8	915113-6	Nut — Nylock $\frac{3}{8}$ -16	33	64	1030	Fitting — Grease	1
9	5217	Shaft — Spindle	3	65	4387	Pulley — Idler	1
10	1515	Bearing — Ball	3	66	4974	Pulley — Idler	1
11	S-51-162	Snap — Ring $1\frac{1}{8}$ Bore	3	67	4567	Bearing — Ball	2
12	3716	Cup — Spindle	3	68	S-51-137	Snap Ring $1\frac{1}{8}$ Bore	2
13	933211	Roll — Pin $\frac{1}{4}$ Dia. x $\frac{3}{4}$	6	69	908035-6	Bolt — Nylock $\frac{3}{8}$ -16 x $1\frac{1}{4}$	2
14	4380	Blade — Rotary 16"	3	70	4286	Shaft — Idler Support	1
15	1336	Washer — Dome	3	71	1278	Washer	4
16	908331-6	Bolt — Nylock $\frac{3}{8}$ -16 x $\frac{7}{8}$	3	72	932026-4	Cotter Pin $\frac{1}{2}$ Dia. x $1\frac{1}{4}$	4
17	4385	Pulley — Spindle Drive	2	73	4382	Rod — Drive Adj.	1
18	4381	Pulley — Spindle Center	1	74	1861	Stud — Shoulder	1
19	1005	Key $\frac{3}{16}$ x $\frac{3}{16}$ x 1	3	75	1393	Stud — Shoulder	1
20	908331-6	Bolt — Hex — Nylock $\frac{3}{8}$ -16 x $\frac{7}{8}$	3	76	5187	Knob	1
21	2844	Washer	3	77	4384	Rod — Lift	1
22	5183	Ass'y. — Idler Plate	1	78	4389	Stud — Lift	1
23	5216	Pulley — Idler	1	79	4296	Ass'y. Bracket — Drive Adj.	1
24	915115-6	Nut — Nylock $\frac{1}{2}$ -13	1	80	900854-4	Bolt — Hex $\frac{3}{8}$ -16 x $8\frac{1}{2}$	1
25	5185	Spring — Extension	1	81	5195	Housing	1
26	5184	Plate Spring Adj.	1	82	4398	Seal	1
27	920009-4	Washer $\frac{3}{8}$ SAE	6	83	4397	Bearing — Needle	1
28	932016-4	Cotter Pin $\frac{1}{8}$ x $\frac{3}{4}$	3	84	4282	Ass'y. Clutch Plate — Complete	1
29	5188	Bolt — Hex — Shoulder	3	85	4874	Ass'y. Clutch Plate — Sleeve	1
30	5190	Bushing — Bronze	1	86	4365	Facing — Clutch	1
31	5189	Spacer — Steel	2	87	4870	Rivet — Clutch Facing	6
32	910261-4	Bolt — Truss HD. $\frac{3}{8}$ -16 x $\frac{7}{8}$	2	88	5197	Shaft — Clutch Engagement	1
33	5191	Cover	1	89	S-50-75	Snap Ring $\frac{3}{4}$ Ext. Truarc	1
34	1385	Screw — Sems — $\frac{1}{4}$ -20 x $\frac{1}{2}$ RD. HD.	4	90	S-52-6	Hair Pin	1
35	4277	Ass'y. Gage Wheel Adj. Rod	1	91	1121	Key $\frac{1}{4}$ x $\frac{1}{4}$ x $1\frac{1}{16}$	1
36	4451	Grip	1	92	5196	Bearing — Ball	1
37	S-52-12	Hairpin	1	93	S-51-112	Snap Ring $1\frac{1}{8}$ Int. Truarc	1
38	4280	Bearing — Cast Iron	2	94	S-51-175	Snap Ring $1\frac{3}{4}$ Int. Truarc	1
39	5169	Wheel	2	95	909848-6	Set Screw — Nylock $\frac{1}{4}$ -20 x $\frac{1}{4}$	1
40	4799	Ass'y. Arm — Gage Wheel	1	96	4383	Bracket	2
41	1230	Spring — Extension	1	97	908015-4	Bolt — Hex — $\frac{5}{16}$ -18 x $\frac{1}{2}$	1
42	932015-4	Cotter Pin $\frac{1}{8}$ x $\frac{1}{2}$	1	98	920082-4	Lockwasher $\frac{5}{16}$ Dia.	2
43	5246	Ass'y. Lift Link — Rear	1	99	4291	Ass'y. Plate — Clutch Rod Mtg.	1
44	4394	Spacer R.H.	1	100	4355	Ass'y. Clutch Rod	1
45	4395	Spacer L.H.	1	101	2709	Knob	1
46	908038-4	Bolt — Hex $\frac{3}{8}$ -16 x 2	1	102	1594	"V" Belt — Blade Drive 107"	1
47	908035-4	Bolt — Hex $\frac{3}{8}$ -16 x $1\frac{1}{4}$	1	103	1595	"V" Belt — Main Drive 67"	1
48	4390	Latch — Rear Lift	1	104	S-56-6	Wrench $\frac{1}{4}$ " Allen ($\frac{1}{8}$ Hex.)	1
49	3624	Spring	1	105	4410	Decal — Emblem	2
50	908023-4	Bolt — Hex $\frac{5}{16}$ -18 x 2	1	106	5194	Decal — Clutch Adj. Instruction	1
51	915112-6	Nut — Nylock $\frac{3}{16}$ -18	5	107	4570	Decal — Caution	2
52	5247	Ass'y. Lift Link — Front	1	108	4580	Decal — Belt Installation	1
53	5180	Bushing	2	109	908035-4	Bolt — Hex — $\frac{3}{8}$ -16 x $1\frac{1}{4}$	1
54	5179	Bushing — Bronze	2	110	4566	Grease Fitting	3
55	4388	Pin — Front Link — Lower	1	111	5245	Bushing — Wheel	2
56	932017-4	Cotter Pin $\frac{1}{8}$ x 1	1				

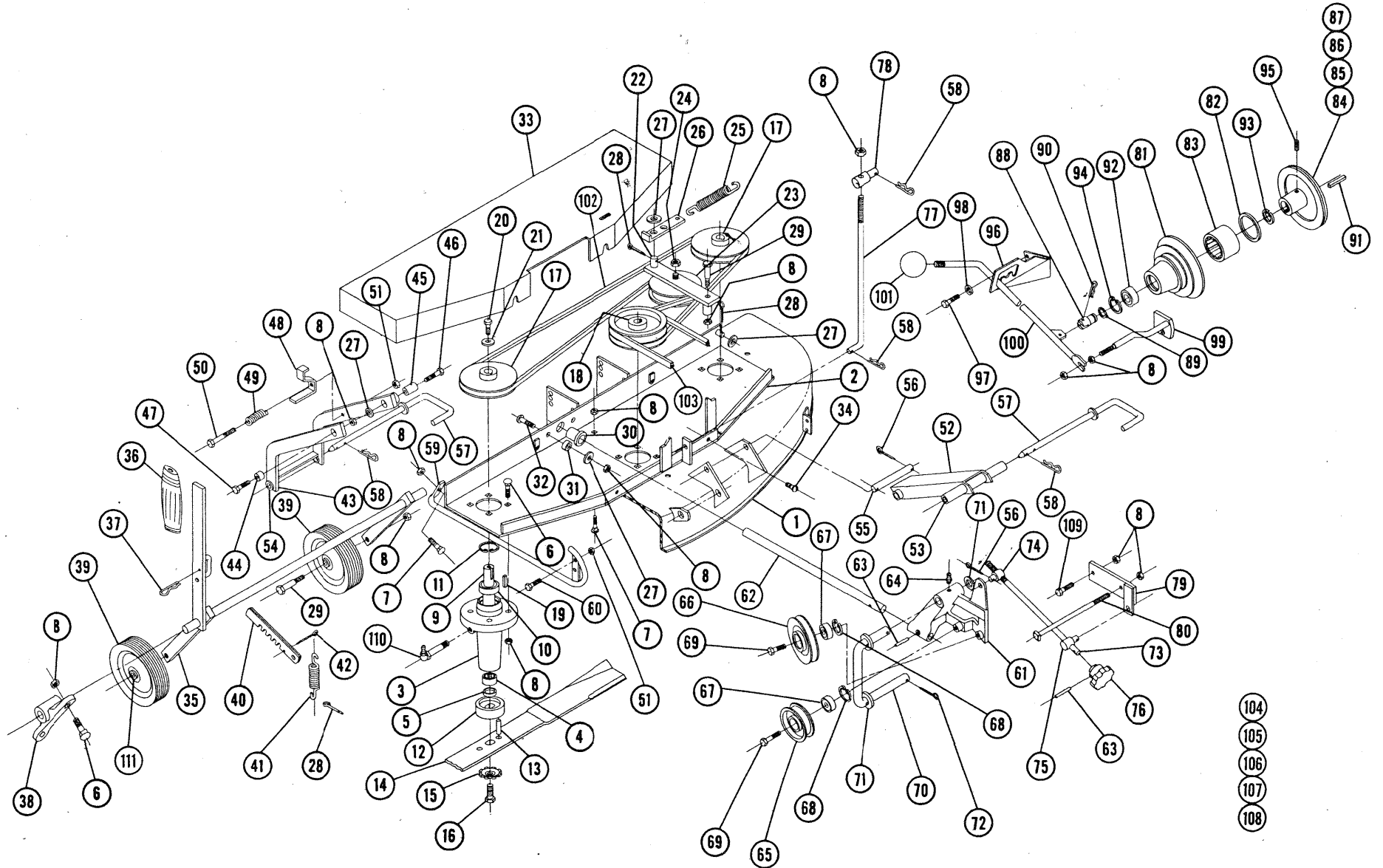

- 104
- 105
- 106
- 107
- 108

Wheel Horse Service Bulletins 1961 - 1990: **#221b** Issued: March 1984
Mower Spindle Service Information 1972 and Prior 42 & 48" Mowers

[Previous](#) [Table of Contents](#) [Next](#)

THIS BULLETIN SUPERSEDES BULLETIN 221A, ISSUED APRIL 1981

To All Dealers:

1. Subject

1.1 The following information is supplied to assist you in identifying available service parts.

NOTE - All mowers using the spindles listed below can be converted to the latest greaseable type refer to Service Bulletin 207A.

2. Service Action

2.1 Spindle Housing #4299 or 8139 (No longer available).

2.1.1 Mowers RM-483, RM-484, RM-485, 5-5481 - Order the parts for S/A 101685 Spindle listed in Par. 2.2 below. Also order a 106848 (Double Groove) or a #106849 (Single Groove) Double "D" pulley, as needed, plus a #11Q242 bolt and #2844 washer, for each spindle being serviced.

2.1.2 Mowers RM-425, RL-426, RL-486, 5-0481, 5-1000, 5-1001, 5-1200 5-1421, 5-1422, 5-1423, 5-1481, 5-1482, 5-1483 - Order the parts for S/A 101685 Spindle listed in Par. 2.2 below.

2.2 S/A 101685 Spindle Assembly (Replaced 101550 Spindle Assembly) No longer available assembled.

2.2.1 Make up the spindle assembly using component parts:

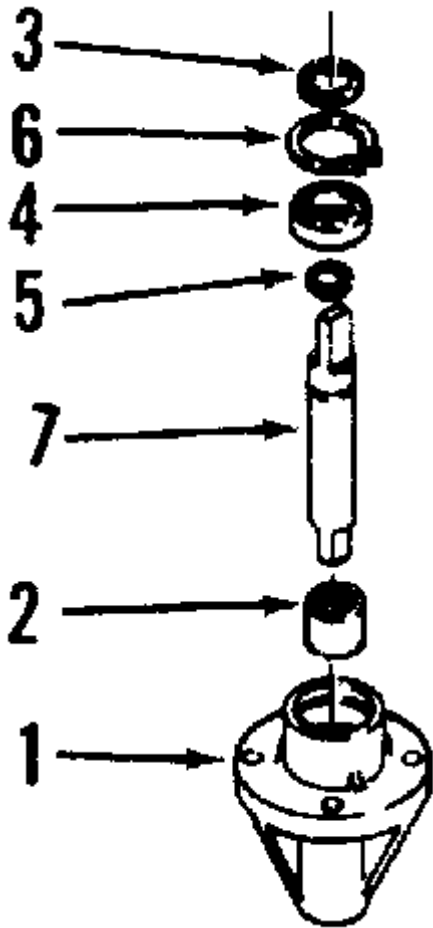

<u>Ref. No.</u>	<u>Part No.</u>	<u>Description</u>
1	102775	Housing
2	100289	Needle Bearing
3	105819	Thrust Washer
4	101411	Ball Bearing
5	104822	Snap Ring (Shaft)
6	936029	Snap Ring (Housing)
7	104982	Shaft

2.2.2 When building a complete assembly from parts, fill housing with 1-1/2 ounces of #2 multi-purpose lithium base grease.

* Bulletin is Greatly Revised to Update Information *

2.3 Spindle Shaft #4393 (No longer available), RM-483 Mower.

2.3.1 Use S/A 109094, which contains:

<u>Qty.</u>	<u>Part No.</u>	<u>Description</u>
1	5217	Spindle Shaft
1	1005	Sq. Key 3/16 x 1
1	110242	Eslok Bolt 3/8-16 x 7/8 Special

1 2844 Special Washer

2.4 Spindle Shaft #5875 (No longer available) - Mowers RM-425, RL-426, RL-486, 5-0481, 5-1000, 5-1001, 5-1200, 5-1421, 5-1422, 5-1423, 5-1481, 5-1482, 5-1483.

2.4.1 S/A 101686 replaces #5875 shaft. Part Numbers and assembly follow:

<u>Qty.</u>	<u>Part No.</u>	<u>Description</u>
1	104982	Shaft
1	104822	Snap Ring (Below Ball Bearing, in snap ring groove)
1	105819	Washer (Between Pulley & Ball Bearing)