



KIT 604I

SERVICE ASSEMBLY KIT FOR RM-483 MOWER LEVELING ROD BEARING

TO INSTALL

- I. Fig. 1 - Remove welded wear plate (1) grind or file off excessive weld.
- II. Fig. 1 - Use template (Fig. III) to center punch for two additional holes. Drill two 13/32 holes for 3/8" bolts.
- III. Fig. 2 - Install service assembly as illustrated with bolts and spacer provided.

IMPORTANT - Add a few drops of oil daily to leveling rod to lubricate bearing.

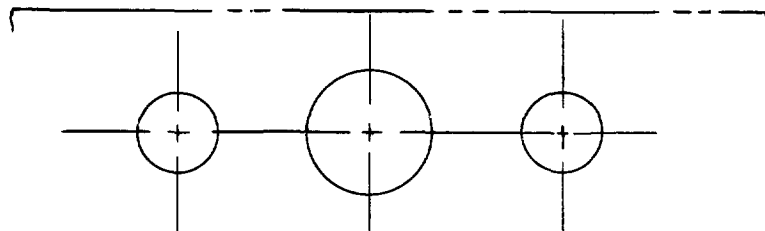
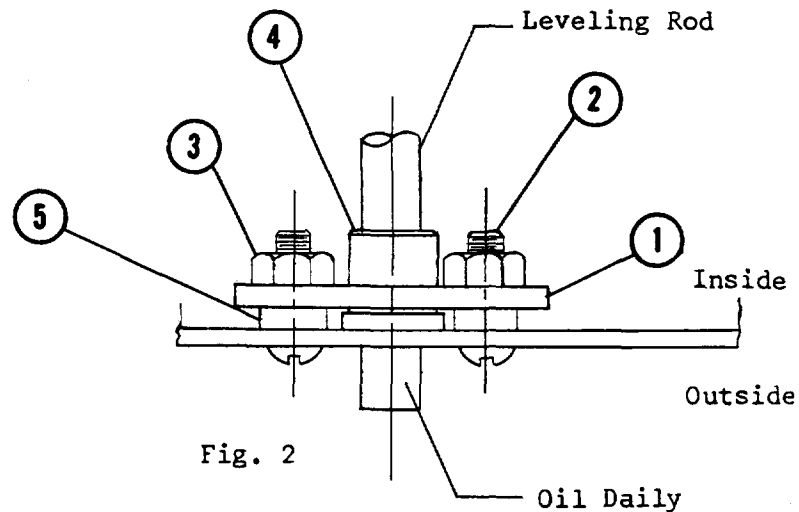
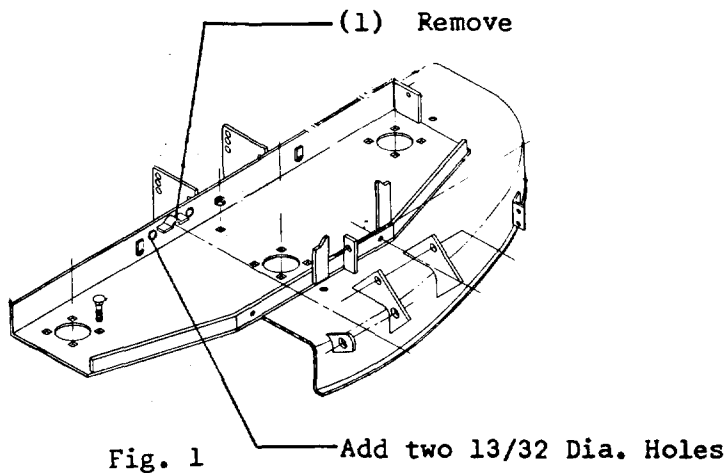

PARTS LIST

Ref. No.	Part No.	Description	No. Req'd.
1	5198	Plate	1
2	909086-4	Bolt 3/8-16 x 1 RD.HD.	2
3	915113-6	Nut 3/8-16 Nylok	2
4	1536	Spacer	2
5	5190	Bushing	1

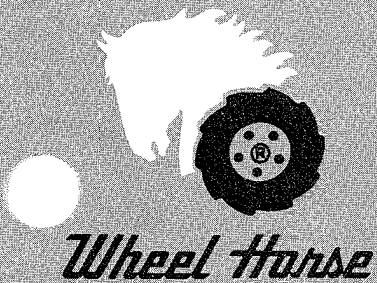

Service Bulletin

45

JUNE 24, 1963

TO OUR DISTRIBUTORS AND DEALERS

SUBJECT: RM-483 LEVELING ROD BEARING

WE HAVE HAD SOME REPORTS OF EXCESSIVE WEAR AT THE POINT WHERE THE LEVELING ROD, PART NUMBER 4399 GOES THROUGH THE CHANNEL ASSEMBLY, PART NUMBER 4265.

WE HAVE DEVELOPED A KIT 6041 (COPY ATTACHED) WHICH PROVIDES AN EXCELLENT BEARING SURFACE FOR THIS ROD.

THESE KITS ARE AVAILABLE FOR IMMEDIATE SHIPMENT.

FLAT LABOR RATE -----\$3.00

D. J. Palbykin
D. J. PALBYKIN

CUSTOMER RELATIONS MANAGER

DJP:CSU
ATTACHED