

## PARTS LIST AND INSTRUCTIONS

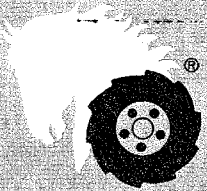

*Wheel Horse*

WHEEL-HORSE PRODUCTS, INC. • SOUTH BEND, IND.

# ROTARY MOWER

## MODELS

### 5-1422, 5-1423

### 5-1000 & 5-1001

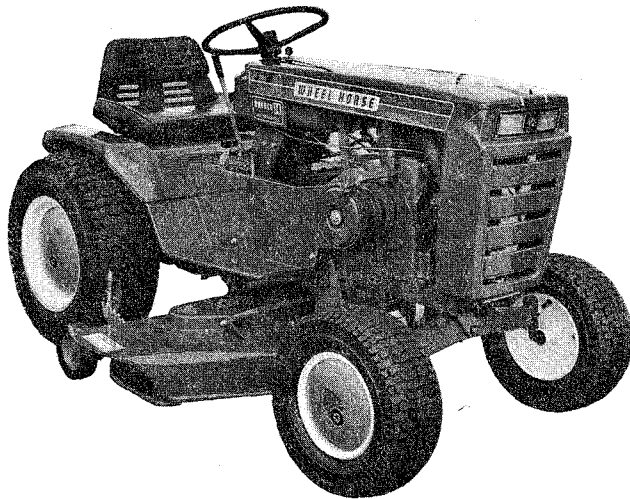

### DESCRIPTION

This mower is designed to fit long frame (45½" wheel-base) 10, 12, & 14 h.p. tractors. The speed hitch parts marked with an asterisk on page 4 are factory installed on all 1970-71 long frame tractors and are included only with mower model 5-1422. To mount the other models on a tractor not so equipped, Speed Hitch Accessory #8-5231 must be purchased and installed separately.

The tractor must also be equipped with a power take-off (P.T.O.) clutch to drive the mower. These are also standard equipment on all 1970-71 and some prior model tractors. They may be purchased as an accessory for all other models.

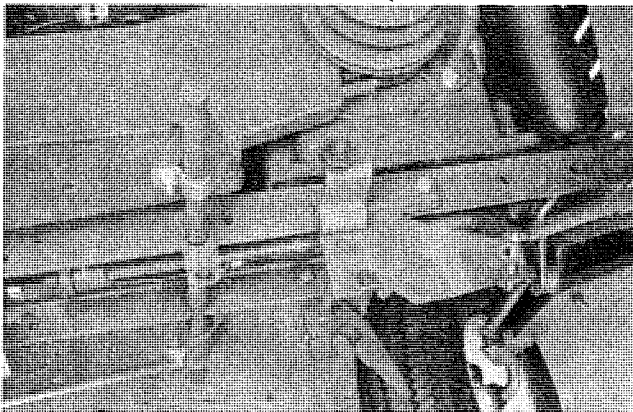

FIGURE 1

### ASSEMBLY INSTRUCTIONS

Fasten the speed hitch parts (with model 5-1422 only) to the tractor frame as shown in Figure 1, using ⅜-16 x 1¼ bolts and nuts through the 3rd and 5th holes in the frame side rails. Loosen and lift the R.H. foot rest and slide the cam arm on the foot rest support — stud pointing outward — as shown in Figure 1.

Referring to item numbers in the exploded view drawing (P. 4), mount the idler pulley (54) with bolt (58) and nut (59) through the lower hole in the R.H. mounting plate (48). Install wheels (40) on the gage wheel support (38) with shoulder bolts (41) and jam nuts (42). Note: The longer hub extension on each wheel goes next to the gage wheel support. Attach the lift rod (25) to the mower support (24) from the right side as shown and secure with a hairpin cotter (26). Slide the lift stud (28) on the lift rod and follow it with a ⅜-16 elastic stop nut (27).

### MOWER INSTALLATION

Pull the speed hitch latch handle forward to the open position and hold it in position by inserting the hairpin cotter in the front hole of the L.H. mounting plate.

Turn the tractor wheel all the way to the left and, with the mower wheels in the lowest cutting position, slide the mower under the tractor from the right side. Center the mower support shaft below the speed hitch slot.

Lower the tractor lift lever and install the lift rod stud in the front hole of the lever from the left side and secure it with a hairpin cotter. With the aid of the lift lever, raise the mower until the mower support shaft is even with the bottom of the speed hitch (Fig. 2). Insert the support shaft in the speed hitch. Close and lock the speed hitch with the hairpin cotter.

Lower the mower. Lubricate the cam arm stud (remove paint if necessary) and the pivot arm shaft (upper left Fig. 2). Slide the pivot arm assembly on the pivot arm shaft and at the same time slide the cam arm stud into the end hole of the pivot arm. Install the retaining "E" ring on the pivot arm shaft and the hairpin cotter on the cam arm stud.

Swing the cam lever (and flat idler) assembly forward and, from the outside, pass the R.H. belt strand over the lever and under the flat idler. Then raise the lever and position it in the groove of the roller bushing (Fig. 3).

On manual P.T.O. models, remove the clutch control rod; on electric P.T.O. models, disconnect the

clutch wire and, depending on type of clutch, either remove the bracket from the engine or remove the clevis pin and rotate the clutch arm away from the clutch bracket so the mower belt can be installed. Loosen the belt adjuster (see BELT ADJUSTMENT) and thread the belt on the idler pulleys and P.T.O. according to the decal on the mower deck and as shown in Figure 3. Reassemble the P.T.O. clutch.

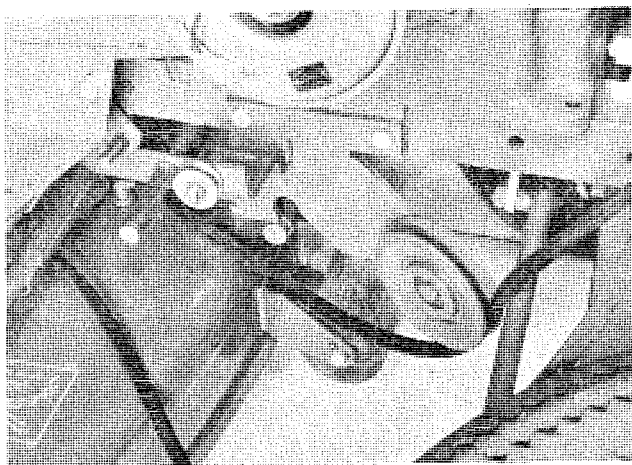

FIGURE 2

### LIFT ADJUSTMENTS

Raise the mower to transport position with the tractor lift lever. If the mower support does not lock solidly against the tractor frame, adjust the length of the lift rod (Item 25, exploded view) by threading the nut (27) down the rod as necessary until it does.

With the mower in raised position, adjust the rubber-tipped leveler at the front of the mower support until the mower deck is level. Loosen the lock nut before attempting to turn the leveler, and tighten it securely after completing the adjustment.

### BELT ADJUSTMENT

Proper belt tension when measured with a belt tension gage is 40 to 50 lbs. When forcing the belt strands together as shown in Figure 4, the distance should be  $2\frac{3}{4}$  to 3 inches. Both measurements are taken with the mower lowered and the gage wheels set at the lowest cutting height.

To adjust belt tension, loosen the  $\frac{3}{8}$  bolt in the slot at the side of the cam lever (Fig. 4) and turn the adjusting nut at the rear of the cam lever clockwise to loosen — counter-clockwise to tighten the belt.

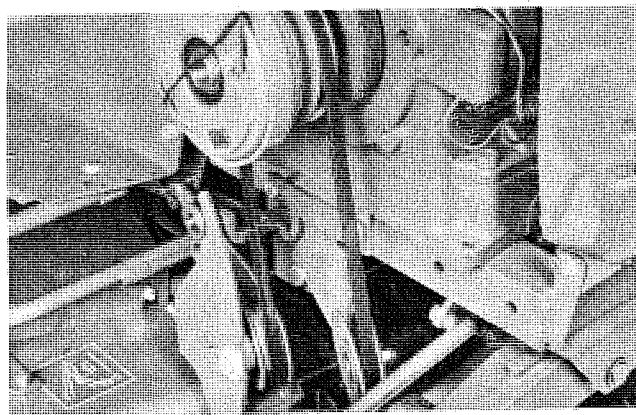

FIGURE 3

Note: Some initial belt stretching is normal during the first few hours of use. It is advisable to check and readjust belt tension as necessary after the first two or three hours the mower is used and again after about thirty hours.

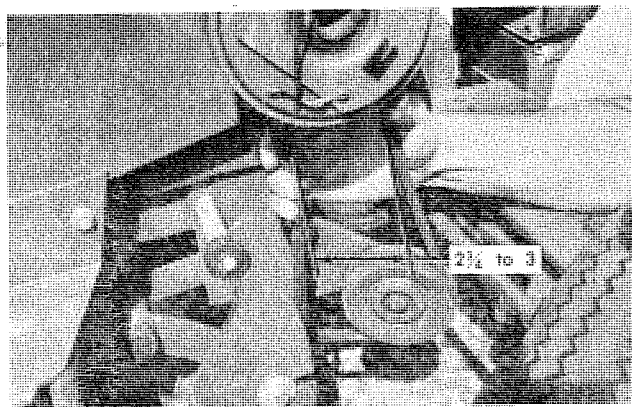

FIGURE 4

### MOWER REMOVAL

Loosen the belt tension (see BELT ADJUSTMENT), dismantle the P.T.O. clutch as necessary and remove the belt. Remove the hairpin cotter from the cam arm stud and "E" ring from the pivot arm shaft and remove the pivot arm assembly.

Set the mower gage wheels at the lowest cutting height and move the tractor lift lever to its lowest position. Remove the hairpin cotter from the lift rod stud and pull the stud out of the hole in the lift lever. Remove the hairpin cotter and unlatch the speed hitch allowing the mower support to drop out of the hitch. Turn the tractor front wheels to the left and pull the mower assembly out to the right side of the tractor.

Note: The cam arm assembly may be left on the foot rest support. If the mower is to be stored, the pivot arm assembly (with cam lever and flat idler pulley) should be reinstalled on the pivot arm shaft and retained with the "E" ring.

### OPERATING INSTRUCTIONS

1. Be sure the P.T.O. is disengaged (Switch button pushed in on electric models; control rod to the right on manual models).
2. Raise the mower with the tractor lift lever and move the height adjusting fork to the quadrant notch for the cutting height desired. Recommended cutting height is two to three inches.
3. Lower the mower, start the engine and run it at full governed speed (throttle control pulled out to the limit stop). This is very important because the mower is designed to give maximum performance at full r.p.m.

It is also very important to mower belt life that the engine be running at least half speed before engaging the P.T.O. **Never run the engine at less than one-half speed with the P.T.O. engaged.**

4. Engage the P.T.O. to start the mower and mow with the engine running at full governed speed in 2nd gear with a mechanical transmission tractor or at  $\frac{1}{2}$  lever travel (approximately  $2\frac{1}{2}$  m.p.h.) with an automatic transmission. If ground speed is too fast, mowing will be uneven because the mower

blades will not have time to lift grass blades into cutting position as the mower passes over them. When rough cutting extra tall or heavy grass and weeds, raise the mower to travel position and cut. It may be necessary to slow to about 1½ m.p.h. Then recut at normal height.

## MAINTENANCE

### Lubrication

Lubricate blade spindles every 50 hours with a pressure grease gun. On some models lubricate the pivot arm assembly and mower gage wheels with a grease gun at intervals of 8 to 10 hours. Models not equipped with fittings should be lubricated with engine oil at these locations.

### Blades

Sharpen blades often; dull blades tear the grass and turn the cut brown and unsightly. When blades become dull, remove the mower from the tractor and remove the blades. File or grind the blades evenly, taking care to retain the original cutting edge angle and blade balance. Reinstall the blades, making sure

the pins protruding from the spindle cups engage the blades properly. The side of the blade with the lift area (turned up section) must be installed facing the mower deck. Tighten the blade attaching screws to a torque of 35 Ft./Lbs. These screws, Part No. 908033-5 should be replaced after every two or three times they are removed and reinstalled.

### Belts

The mower must be removed from the tractor, and the belt mower (Item 79, exploded view) removed in order to replace either mower belt. Replace the drive belt by following applicable instructions under MOWER REMOVAL and MOWER INSTALLATION. Install a new spindle belt in accordance with the belt diagram decal on the belt cover. Be sure to purchase genuine Wheel Horse belts for replacement purposes. They are designed specifically for each application.

**IMPORTANT** — Clean the underside of the mower deck frequently to prevent the accumulation of matted clippings which seriously impair the mower's ability to lift grass blades upright into cutting position and to discharge clippings evenly.

## PARTS LIST

When ordering parts always list Part No. and name of part. Parts available only through Authorized Dealers.  
(Specifications subject to change without notice.)

Item No.	Part No.	Description	No. Req'd	Item No.	Part No.	Description	No. Req'd
1	6690	Ass'y. Deck 42" Mower	1	51	8174	Cam Roller Support	1
2	8139	Housing — Spindle	3	52	6714	Bushing	1
3	1508	Needle Bearing	3	53	MW-4564	"E" Ring ⅜ Shaft	1
4	100441	Seal — Oil	3	54	4974	Pulley — Idler	1
5	4566	Fitting — Grease	2	55	4567	Ball Bearing	2
6	7911	Nipple ⅛ Pipe x 1" Long	1	56	936024	Snap Ring 1⅜ Bore	2
7	943021	Elbow ⅛ Pipe x 90°	1	57	6638	Spacer	1
8	7891	Grease Fitting 90°	1	58	908036-4	Bolt Hex ⅜-16 x 1½	1
9	908032-6	Bolt — Hex Nylok ⅜-16 x ¾	15	59	915113-6	Nut ⅜-16 Nylok	5
10	5875	Shaft Spindle	3	60	6715	Ass'y. Bar — Idler Support	1
11	5951	Washer — Special — Double "D"	3	61	6719	Pulley — Flat Idler	1
12	101480	Ball Bearing	3	62	6720	Block — Slide	2
13	936029	Snap Ring 1⅜ Bore	3	63	900039-4	Bolt Carriage ⅜-18 x 1¼	3
14	6692	Pulley — Middle Drive	1	64	915662-4	Nut ⅜-18 Elastic Stop	5
15	5877	Pulley — Right and Left	2	65	920008-4	Washer ⅜ SAE	5
16	2844	Washer — Special	4	66	6651	Spring	1
17	8200	Cup — Spindle	3	67	900040-4	Bolt Carriage ⅜-18 x 1½	1
18	933211	Roll Pin ¼ x ¾	6	68	6748	Slide	4
19	6693*	Blade 14"	3	69	6747	Angle	1
20	1336	Washer — Dome	3	70	8162	Fork	1
21	5240	Ass'y. — Roller — w/2 1974 Bushings	3	71	8202	Spring	1
22	101881	Pin — Roller	1	72	9038	Grip	1
23	932017-4	Pin — Cotter ⅜ x 1	1	73	6723	Clip — Axle	2
24	6694	Ass'y. — Support — Mower	1	74	6724	Support — Axle	2
25	6699	Rod — Lift	1	75	900066-4	Bolt Carriage ⅜-16 x 1¼	2
26	933504-4	Hairpin Cotter	3	76	900064-4	Bolt Carriage ⅜-16 x 1¼	2
27	915663-4	Nut ⅜-16 Elastic Stop	14	77	6725	Arm Pivot	1
28	6739	Stud — Lift	1	78	4736	"E" Ring ⅜ Shaft	2
29	6702	Bracket — Deck R.H.	1	79	6726	Cover	1
30	6703	Bracket — Deck L.H.	1	80	5924	Nut Elastic Stop #10-32	10
31	900062-4	Bolt Carriage ⅜-16 x ¾	6	81	915112-6	Nut ⅜-18 Nylok	2
32	2138	Spacer	2	82	6727	Ass'y. Cam Arm	1
33	908035-4	Bolt Hex ⅜-16 x 1¼	4	83	932009-4	Cotter Pin	1
34	920009-4	Washer ⅜ SAE	6	84	7068	Ass'y. Cam Lever	1
35	100087	Leveler	1	85	6733	Ass'y. Idler Support	1
36	915112-4	Nut Hex Plain ⅜-18	1	86	6736	Nut	1
37	6701	Quadrant	1	87	6814	Spacer	1
38	101484	Ass'y. — Gage Wheel Support	1	88	920156	Lockwasher ⅜ Dia. Internal	1
39	5701	"E" Ring ½" Shaft	4	89	6740	Pullley — Idler	1
40	5305	Wheel — w/2 5306 Bushings	2	90	908037-4	Bolt Hex ⅜-16 x 1¾	1
41	5188	Bolt — Shoulder	2	91	908033-4	Bolt Hex ⅜-16 x ⅞	1
42	915236-4	⅜-16 Jam Nut	2	92	920083-4	Lockwasher ⅜ Plain	2
43	933188	Roll Pin ⅜ Dia. x 1	2	93	9782	"V" Belt	1
44	920011-4	Washer ½ SAE	3	94	6738	"V" Belt	1
45	6710	Ass'y. Latch and Shaft	1	95	4580	Decal — Belt Installation	1
46	933512-4	Hairpin	1	96	4410	Decal — Emblem	1
47	6704	Pin	1	97	4570	Decal	2
48	6712	Plate R.H. Mounting	1	98	100333	Decal — Height Adjustment	1
49	4497	Plate L.H. Mounting	1	99	908033-5	Bolt — Hex Nylok ⅜-16 x ⅞	3
50	908034-4	Bolt Hex ⅜-16 x 1	2	100	100710**	Ass'y. — Sealed Spindle Bearing	3

\*Order Kit No. 100200 (3 blade kit)

\*\*Model 5-1001 only

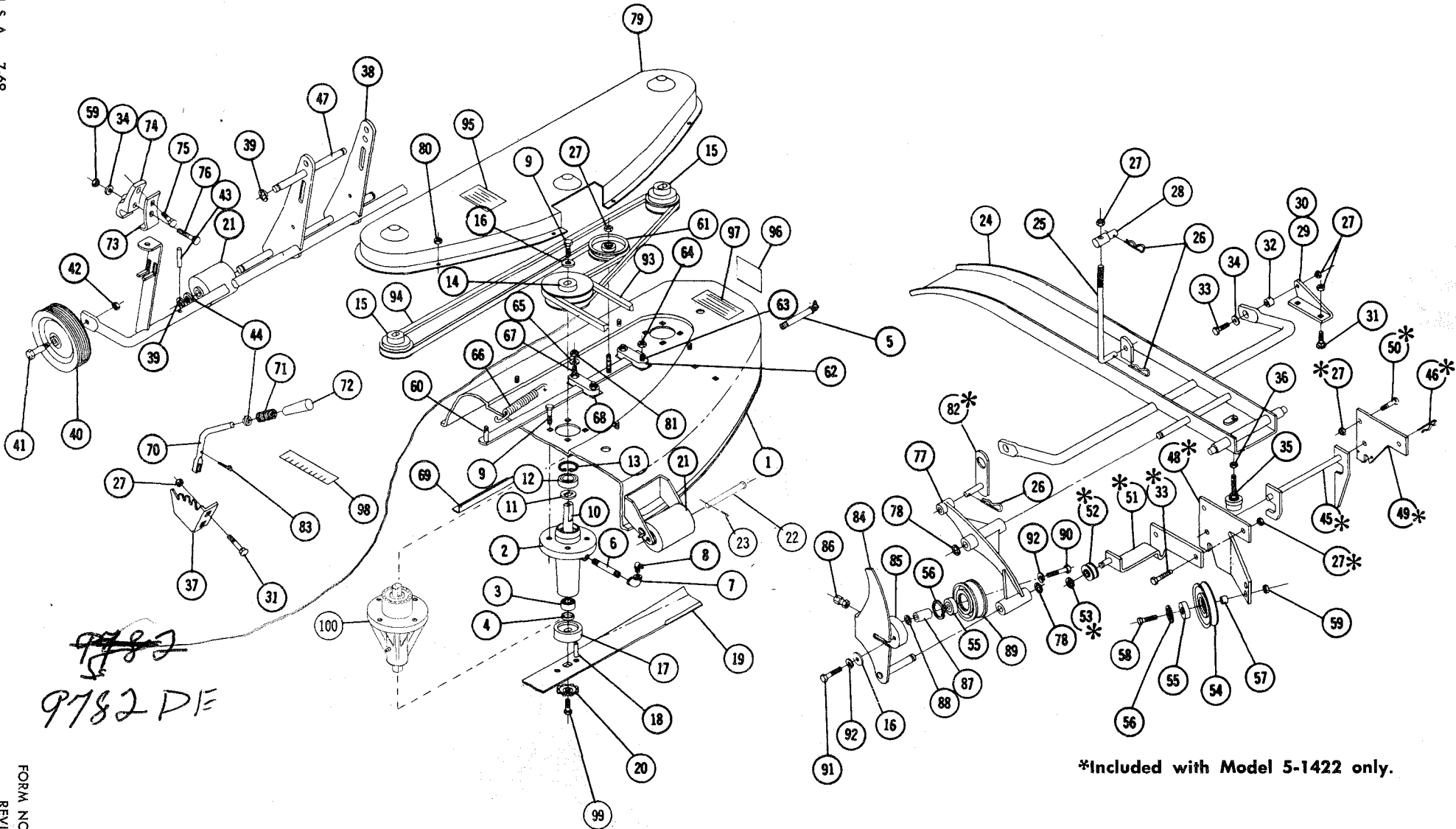

\*Included with Model 5-1422 only.

---

Wheel Horse Service Bulletins 1961 - 1990: **#120** Issued: February 1970  
**6725 Pivot Arm Modification - 5-1483 and 5-1423 Mower Attachments**

[Previous](#)   [Table of Contents](#)   [Next](#)

---

When setting up 48 and 42 inch mowers in the serial number range listed below, you may discover on some that the "E" ring cannot be installed to retain the 6725 pivot arm because the ring groove is covered by the arm.

The correction for this is to remove material as necessary from the OUTER face of the pivot arm boss until the pivot pin "E" ring groove is exposed with the arm in place.

#### INSTRUCTIONS

1. Measure the distance "D" from the lift frame channel to the "E" ring groove on the pivot pin. (See Illustration)

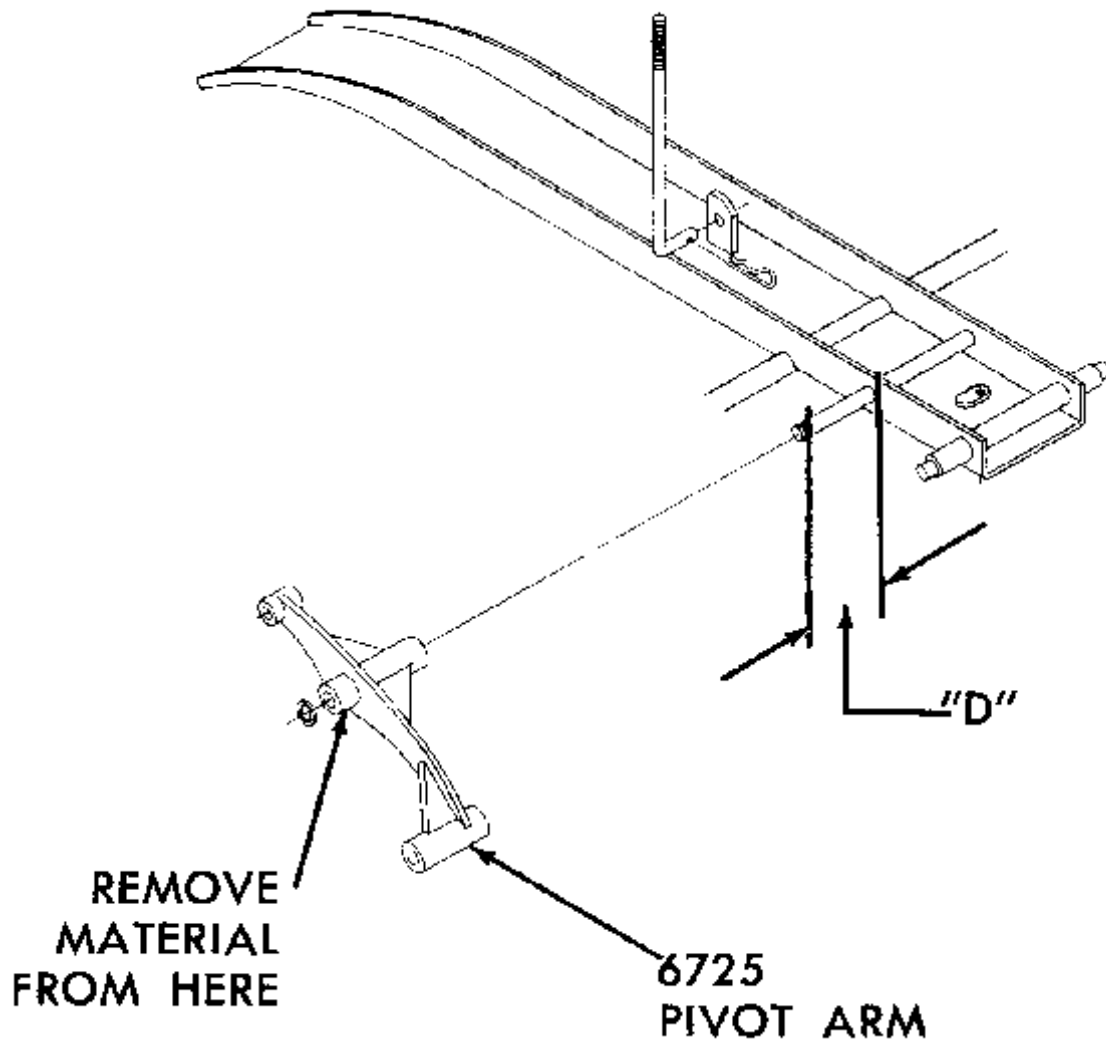

2. Subtract this measurement from 3". The difference is the amount to remove from the face of the pivot arm.

EXAMPLE: Distance "D" = 2 15/16"; remove 1/16" from arm.

Material can be removed from the arm by milling, filing or grinding. Care should be taken to keep the outer face as near as possible parallel with the inner face.

#### **SERIAL NUMBER RANGE OF MOWERS AFFECTED**

MODEL		MODEL	
5-1483		5-1423	
FROM	TO	FROM	TO
705901	706400	701403	702900
706901	707100	703901	704790

Atwood S. Kidder

## Customer Relations Manager

---

Wheel Horse Service Bulletins 1961 - 1990: **#221b** Issued: March 1984  
**Mower Spindle Service Information 1972 and Prior 42 & 48" Mowers**

[Previous](#)   [Table of Contents](#)   [Next](#)

---

THIS BULLETIN SUPERSEDES BULLETIN 221A, ISSUED APRIL 1981

**To All Dealers:**

1. Subject

1.1 The following information is supplied to assist you in identifying available service parts.

NOTE - All mowers using the spindles listed below can be converted to the latest greaseable type refer to Service Bulletin 207A.

2. Service Action

2.1 Spindle Housing #4299 or 8139 (No longer available).

2.1.1 Mowers RM-483, RM-484, RM-485, 5-5481 - Order the parts for S/A 101685 Spindle listed in Par. 2.2 below. Also order a 106848 (Double Groove) or a #106849 (Single Groove) Double "D" pulley, as needed, plus a #11Q242 bolt and #2844 washer, for each spindle being serviced.

2.1.2 Mowers RM-425, RL-426, RL-486, 5-0481, 5-1000, 5-1001, 5-1200 5-1421, 5-1422, 5-1423, 5-1481, 5-1482, 5-1483 - Order the parts for S/A 101685 Spindle listed in Par. 2.2 below.

2.2 S/A 101685 Spindle Assembly (Replaced 101550 Spindle Assembly) No longer available assembled.

2.2.1 Make up the spindle assembly using component parts:



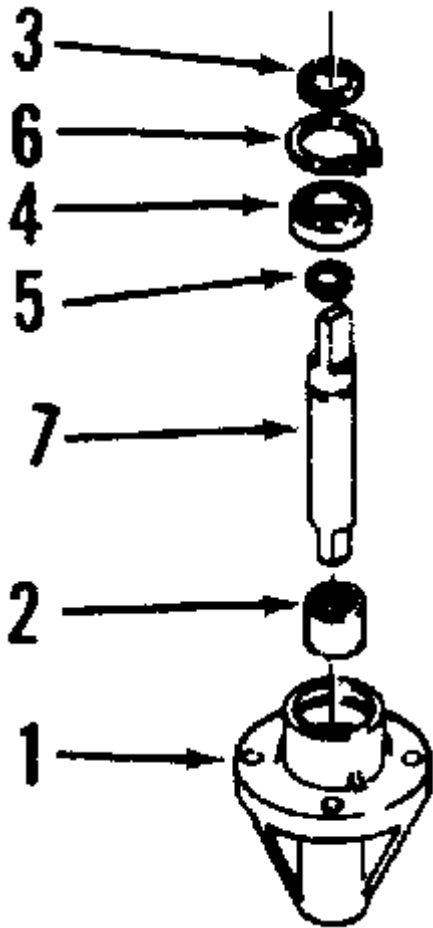

Ref. No.	Part No.	Description
1	102775	Housing
2	100289	Needle Bearing
3	105819	Thrust Washer
4	101411	Ball Bearing
5	104822	Snap Ring (Shaft)
6	936029	Snap Ring (Housing)
7	104982	Shaft

2.2.2 When building a complete assembly from parts, fill housing with 1-1/2 ounces of #2 multi-purpose lithium base grease.

\* Bulletin is Greatly Revised to Update Information \*

2.3 Spindle Shaft #4393 (No longer available), RM-483 Mower.

2.3.1 Use S/A 109094, which contains:

Qty.	Part No.	Description
1	5217	Spindle Shaft
1	1005	Sq. Key 3/16 x 1
1	110242	Eslok Bolt 3/8-16 x 7/8 Special

1            2844            Special Washer

2.4 Spindle Shaft #5875 (No longer available) - Mowers RM-425, RL-426, RL-486, 5-0481, 5-1000, 5-1001, 5-1200, 5-1421, 5-1422, 5-1423, 5-1481, 5-1482, 5-1483.

2.4.1 S/A 101686 replaces #5875 shaft. Part Numbers and assembly follow:

<u>Qty.</u>	<u>Part No.</u>	<u>Description</u>
1	104982	Shaft
1	104822	Snap Ring (Below Ball Bearing, in snap ring groove)
1	105819	Washer (Between Pulley & Ball Bearing)