

# PARTS LIST AND INSTRUCTIONS

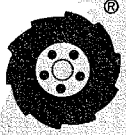

*Wheel Horse*

WHEEL-HORSE PRODUCTS, INC. • SOUTH BEND, IND.

## ROTARY MOWER

### MODELS

5-7365, 5-7366 } REAR DISCHARGE  
5-0600, 5-0601 }  
5-0710, 5-0711 – SIDE DISCHARGE

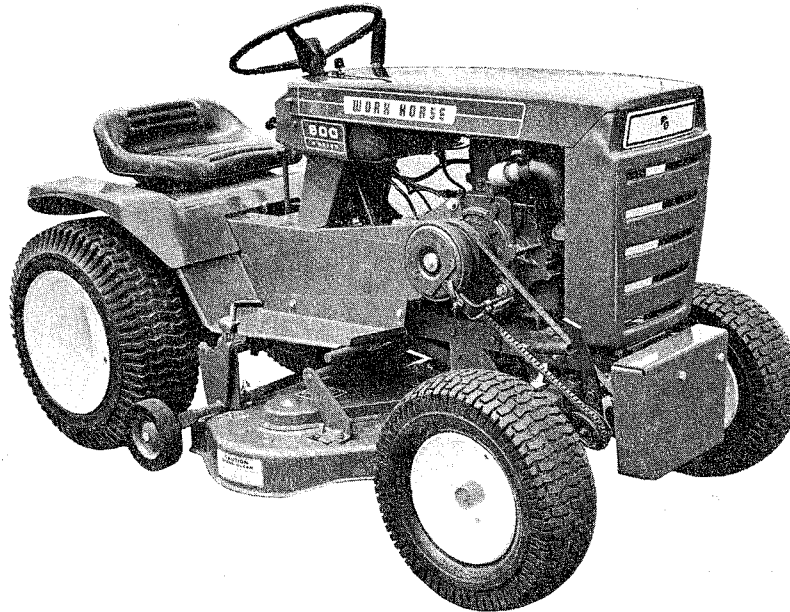

### DESCRIPTION

This mower is designed to be used with long frame ( $45\frac{1}{2}$ " ) wheel base tractors. The mower and all attaching parts are packed in one carton. The mower is completely assembled except for attaching the gage wheels and securing the height adjusting fork in place on the quadrant. An installation package containing bolts, nuts, hairpins, a spring anchor, and cotter pin is also provided.

### ASSEMBLY AND INSTALLATION

Swing the height adjusting fork back to a quadrant notch. Raise the spring seat washer, compressing the spring. Insert the cotter pin (Fig. 1) and spread it to trap the spring and washer above it.

Attach the gage wheels to the wheel support with the special shoulder bolts and nuts. Make sure the long hub of each wheel faces inward toward the support (Fig. 2).

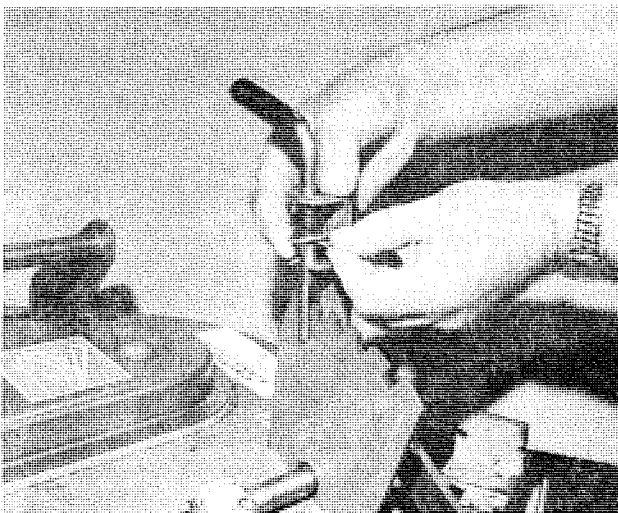

FIGURE 1

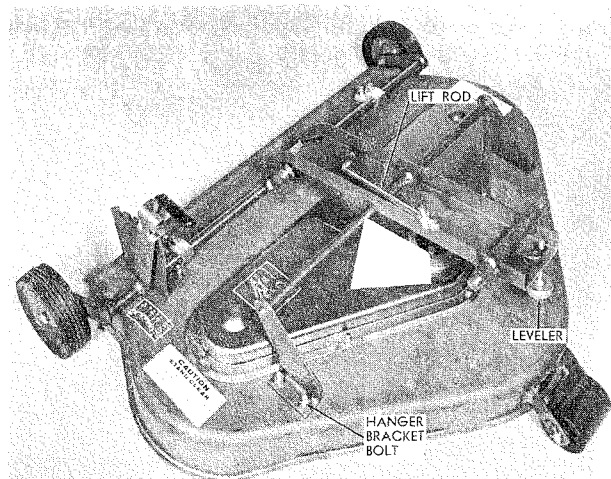

FIGURE 2

Align the holes in the idler support frame with the first two holes in the tractor frame rails. Pass the long (8½") bolt through the front frame hole and matching holes in the support. Secure the bolt with a ⅜-16 elastic stop nut. See Fig. 3 and exploded view drawing.

Insert the ⅜-16 x 1¼" bolt outward through the second hole in the right hand frame side rail and corresponding hole in the idler support. Secure it with a ⅜-16 hex Nylok nut.

Hook the free end of the idler arm spring through the smaller hole in the spring anchor plate and attach the plate to the support mounting bolt with a ⅜-16 hex Nylok nut, run up until it is flush with the end of the bolt (Fig. 3).

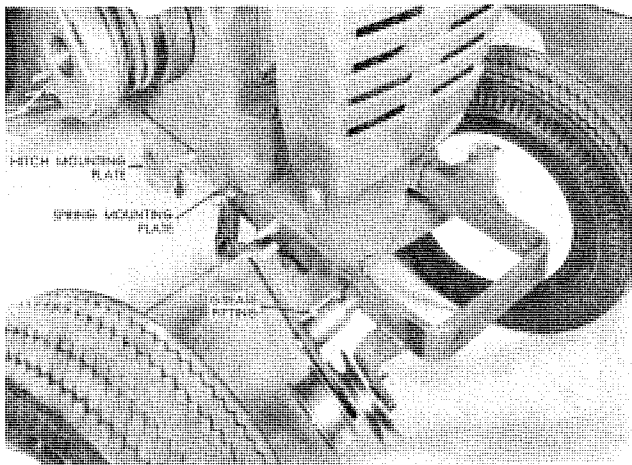

FIGURE 3

Use the ⅜-16 x 1¼" bolt and elastic stop nut in the remaining idler support hole and the left frame rail.

Attach the right hand hitch mounting plate against the outside of the frame side rail with ⅜-16 x 1" bolts and elastic stop nuts through the third and fifth holes of the tractor frame. Hang the latch and shaft assembly in the mounting plate hole (latch handle to the left), and install the left hand hitch mounting plate (Fig. 3 & 4). **NOTE:** Late model tractors have the plates and latch mounted as standard equipment.

Turn the front wheels of the tractor all the way to the left. Slide the mower under the tractor from the right side and center it. Raise the lift frame and guide the pivot shaft ends into the hitch plate notches. Close the latch and secure it with a hairpin cotter through the small hole in the mounting plate ahead of the latch handle. (Fig. 4).

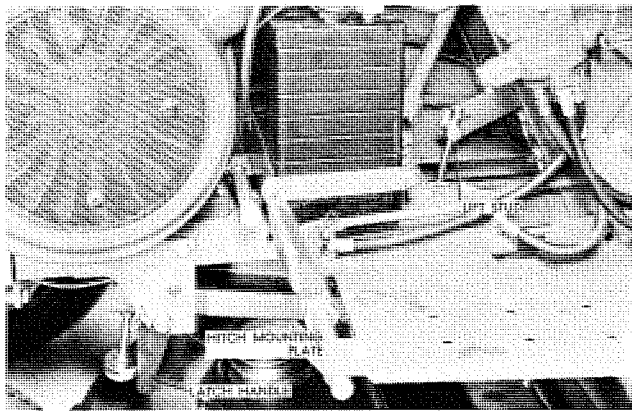

FIGURE 4

Raise the end of the lift rod and insert the lift stud from the left side into the end hole of the tractor lift arm. Secure it with a hairpin cotter. See Figure 4.

Pass a loop of the mower drive belt under the front axle and fit it in the groove of the mower drive pulley. Seat it in the stationary idler pulley and pull it over the top of the power take-off pulley (Fig. 5).

Pull the top of the idler arm forward to swing the movable idler pulley back. Draw the return strand of the belt straight from the bottom of the power take-off pulley and lay it over the flat idler. Release the idler arm and allow the spring to apply tension to the belt (Fig. 5).

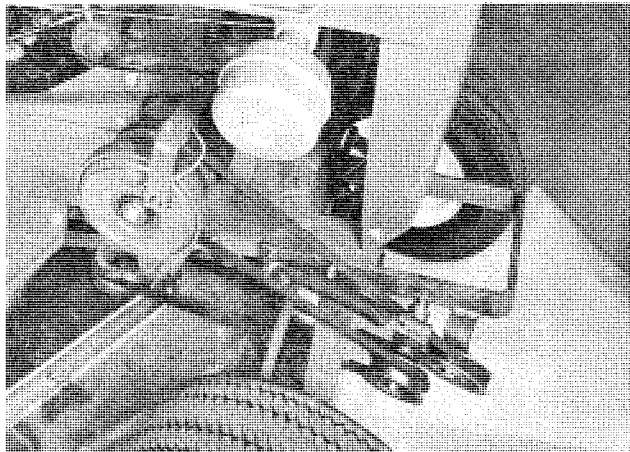

FIGURE 5

Complete the installation by mounting the bolt cover on the front of the idler support frame with two ⅜-16 x 1" bolts and elastic stop nuts. See cover photograph.

The rubber-tipped leveler at the front of the lift frame should be adjusted by turning it in or out until it measures approximately 3" from the tip to the frame, or until the blades are ⅛" lower in front than in back. Loosen the lock nut before attempting to turn the leveler, and tighten it securely after completing the adjustment.

#### MOWER REMOVAL

Set the mower gage wheels in the lowest cutting position and lower the mower with the tractor lift lever.

Pull forward on the upper end of the idler arm to relieve belt tension, and slip the belt off the movable idler pulley. Take the belt off the power take-off pulley and the mower pulley. **Reinstall pin in the electric clutch arm and re-connect wire.**

Remove the hairpin cotter from the lift stud and remove the stud from the tractor lift arm.

Remove the hairpin cotter from the quick hitch, unlatch the hitch and drop the mower lift frame out of the hitch.

Turn the front wheels of the tractor all the way to the left and slide the mower to the right and out from under the tractor.

#### OPERATION

1. Lift the mower with the tractor lift lever to remove weight of the mower from the gauge wheels. **Note:** Never stand on the mower.

2. Move the height adjusting fork to the notch on the quadrant corresponding to the desired cutting height. The recommended cutting height is two to three inches.

3. Disengage the power take-off clutch and lower the mower before starting the tractor engine.

4. Start the engine and engage the power take-off clutch. For best cutting results on average level lawns, operate the tractor at full throttle in 2nd gear with a mechanical transmission, or half speed (approx. 2½ m.p.h.) with an automatic transmission. If ground speed is too fast, mowing will be uneven because the mower blades will not have time to lift each blade of grass into cutting position.

5. To mow extra tall grass or grass containing lots of moisture, raise the mower to the highest position for the first cut using the lowest drive speed. Then recut to normal height.

## MAINTENANCE

The fitting on the idler arm pivot (Fig. 3) and gage wheels should be lubricated with a pressure grease gun after every 8 to 10 hours of operation.

### Blade Maintenance:

Invert the mower. Remove the three blade attaching bolts and special washers. Lift the blades off the

spindles.

File or grind the blades evenly, taking care to retain the original cutting edge angle and blade balance. Reinstall the blades, making sure the pins protruding from the spindle cups engage the blades properly. The side of the blade with the lift area (turned up section) must be installed facing the mower deck. Tighten the blade attaching screws to a torque of 35 Ft./Lbs. These screws, Part No. 908033-6 should be replaced after every two or three times they are removed and reinstalled.

### Mower Belt Replacement:

Be sure to purchase genuine Wheel Horse belts for replacement purposes as these belts are designed specifically for each application.

Remove the hanger bracket bolts (Fig. 2), at the R.H. and L.H. mower deck brackets and remove the lift assembly from the mower. Remove the belt cover nuts and lift the cover off the mower deck.

Remove the old belt and install the new belt in accordance with the belt diagram decal on the belt cover. Reinstall the belt cover and lift assembly.

## PARTS LIST FOR ROTARY MOWER

Parts available only through Authorized Dealers. When ordering parts always list Part No. and name of Part.

(Specifications subject to change without notice.)

Item No.	Part No.	Description	No. Req'd.	Item No.	Part No.	Description	No. Req'd.
1	8385	Deck — Mower	1	44	900067-4	Bolt — Carriage ⅜-16 x 2	2
1	100762	Deck — Mower (5-0710 & 5-0711)	1	45	920009-4	Washer ⅜ SAE	4
2	8389	Housing — Spindle	3	46	9294	Quadrant	1
3	8390	Bearing — Spindle	3	47	900037-4	Bolt — Carriage ⅜-18 x ¾	2
4	900234-4	Bolt Carriage ⅜-16 x 1	12	48	915662-4	Nut ⅜-18 Elastic Stop	2
5	915113-6	Nut — Nylok ⅜-16	14	49	8162	Fork — Height Adjustment	1
6	8391	Pulley	1	50	8202	Spring	1
6	101232	Pulley (5-0601 & 5-0711)	1	51	920011-4	Washer ½ SAE	1
7	8392	Pulley — Ends	2	52	932009-4	Cotter Pin ⅜ x 1	1
7	101231	Pulley — Ends (5-0601 & 5-0711)	2	53	9038	Grip	1
8	2844	Washer — Special	2	54	5305	Wheel	2
9	5951	Washer — Special Double "D"	3	55	5188	Bolt — Shoulder	2
10	908032-6	Bolt — Nylok ⅜-16 x ¾	2	56	9295	Bracket — Hanger L.H.	1
11	8200	Drive — Blade	3	57	9296	Bracket — Hanger R.H.	1
12	933211	Roll Pin ¼ x ¾	6	58	900063-4	Bolt — Carriage ⅜-16 x 1	4
13	9187 <sup>▲</sup>	Blade 14"	1	59	6229	Bearing — Bronze	2
13	100776 <sup>▲▲</sup>	Blade 14" (5-0710 & 5-0711)	1	60	7932	Cover	1
14	9188 <sup>▲</sup>	Blade 12"	2	61	5924	Nut Hex #10-32 Elastic Stop	7
14	100777 <sup>▲▲</sup>	Blade 12" (5-0710 & 5-0711)	2	62	6710	Latch and Shaft	1
15	1336	Washer — Dome	4	63	4497	Plate — Mounting	2
16	908033-6	Bolt — Nylok ⅜-16 x ⅜	4	64	908034-4	Bolt — Hex ⅜-16 x 1	6
17	5240	Roller	1	65	933512-4	Hairpin Cotter	1
18	5241	Shaft — Roller	1	66	9361	Frame — Idler Support	1
19	932017-4	Cotter Pin	2	67	900853-4	Bolt — Hex ⅜-16 x 8	1
20	9256	Bar Idler Support	1	68	908035-4	Bolt — Hex ⅜-16 x 1¼	1
21	7434	Pulley — Flat Idler	1	69	908037-4	Bolt — Hex ⅜-16 x 1¼	2
22	915236-4	Nut ⅜-16 Jam	3	70	9811	Idler Arm Support	1
23	6748	Slide	2	71	1030	Grease Fitting	1
24	6720	Block — Slide	2	72	5618	E-Ring ¼	2
25	900039-4	Bolt — Carriage ⅜-18 x 1¼	3	73	6740	Pulley — Idler	1
26	920008-4	Washer ⅜ SAE	5	74	4570	Decal — Caution	2
27	915112-6	Nut — Hex ⅜-18 Nylok	5	75	4567	Ball Bearing	2
28	6651	Spring	1	76	936024	Snap Ring 1⅜ Bore	2
29	900040-4	Bolt — Carriage ⅜-18 x 1½	1	77	911404-4	Bolt — Hex Special ⅜-16 x 1⅝	1
30	9287	Lift Frame	1	78	6638	Spacer	1
31	6704	Pin	1	79	100071	Spring — Extension	1
32	5701	E-Ring	2	80	100047	Plate — Spring Anchor	1
33	9297	Leveler	1	81	4974	Pulley — Idler	1
34	915113-4	Nut — Hex ⅜-16	1	82	1967	Spacer	1
35	6699	Rod — Lift	1	83	9812	Belt Cover	1
36	933504-4	Hairpin Cotter	2	84	8411	Belt — 77 Mower	1
37	915663-4	Nut — Elastic Stop ⅜-16	19	85	9360	Belt — 97 Drive	1
38	6739	Stud — Lift	1	86	9815	Decal — Belt Installation	1
39	9290	Gage Wheel Support	1	87	100333	Decal — Height Adjustment	1
40	933188	Roll Pin ⅜ x 1	2	88	100284	Bushing	2
41	8406	Support	2	89	100674 <sup>⊕</sup>	Spacer — Pulley (5-0601 & 5-0711)	3
42	8407	Clip	2	90	100675 <sup>⊕</sup>	Ass'y — Sealed Spindle Bearings (5-0601 & 5-0711 only)	3
43	900064-4	Bolt — Carriage ⅜-16 x 1¼	2				

<sup>▲</sup> Order Part No. 8969 (3-Blade Kit)

<sup>▲▲</sup> Order Part No. 101335 (3-Blade Kit)

<sup>⊕</sup> Included in Kit No. 6098 for service replacement of Items 2, 3, & 9 on models other than 5-0601 & 5-0711. Also requires 101231 or 101232 pulley depending on location of replaced spindle assembly.

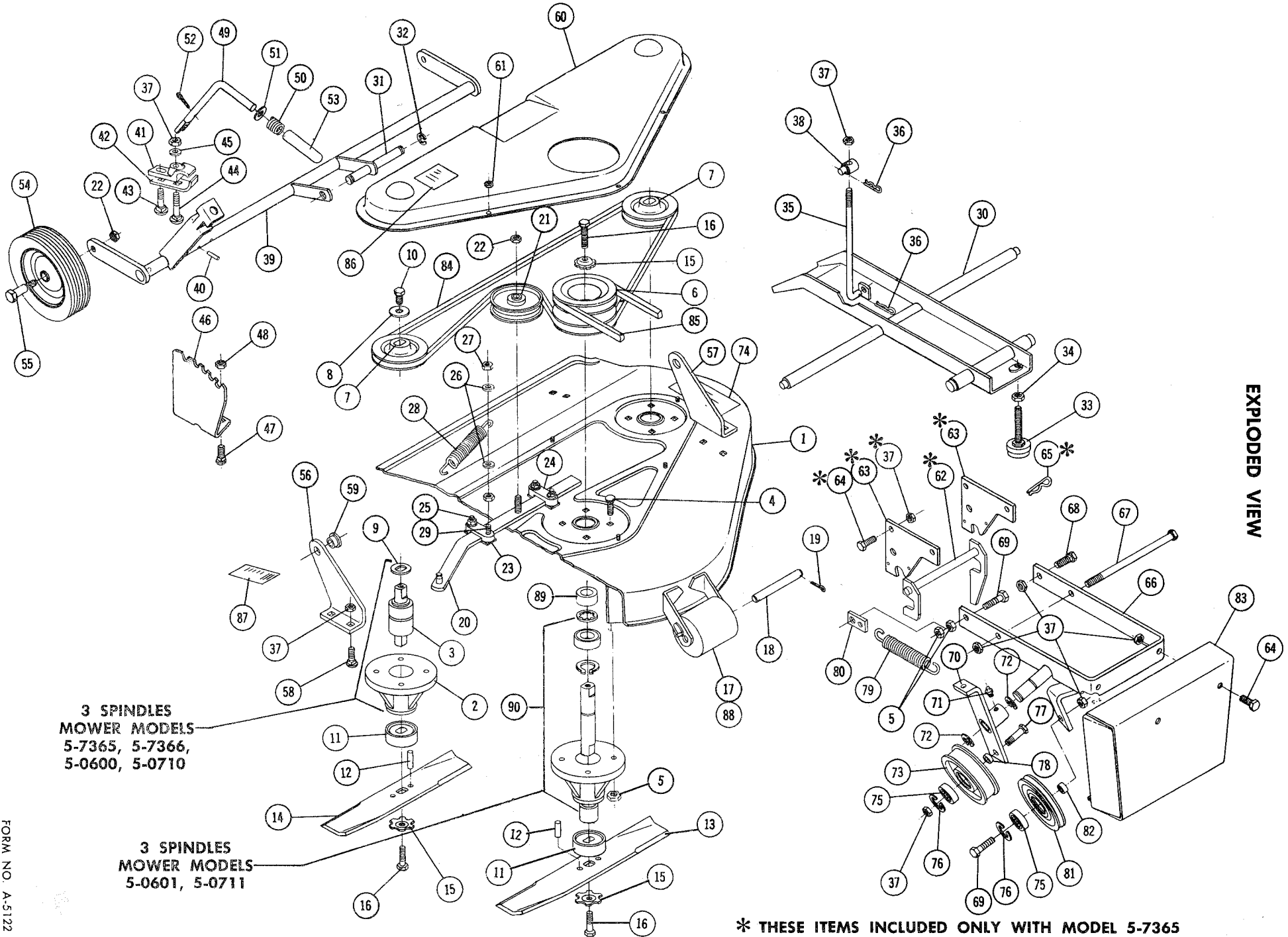

EXPLODED VIEW